

## 18" X 18" INSTRUCTIONS

1. OVERLAP SHEETS, ALIGN PAPER EDGES TO SOLID LINES, AND ADHERE
2. CONNECT RED X WITH PEN TO ALIGN PLUMB BOB
3. CUT ALONG DASHED LINES

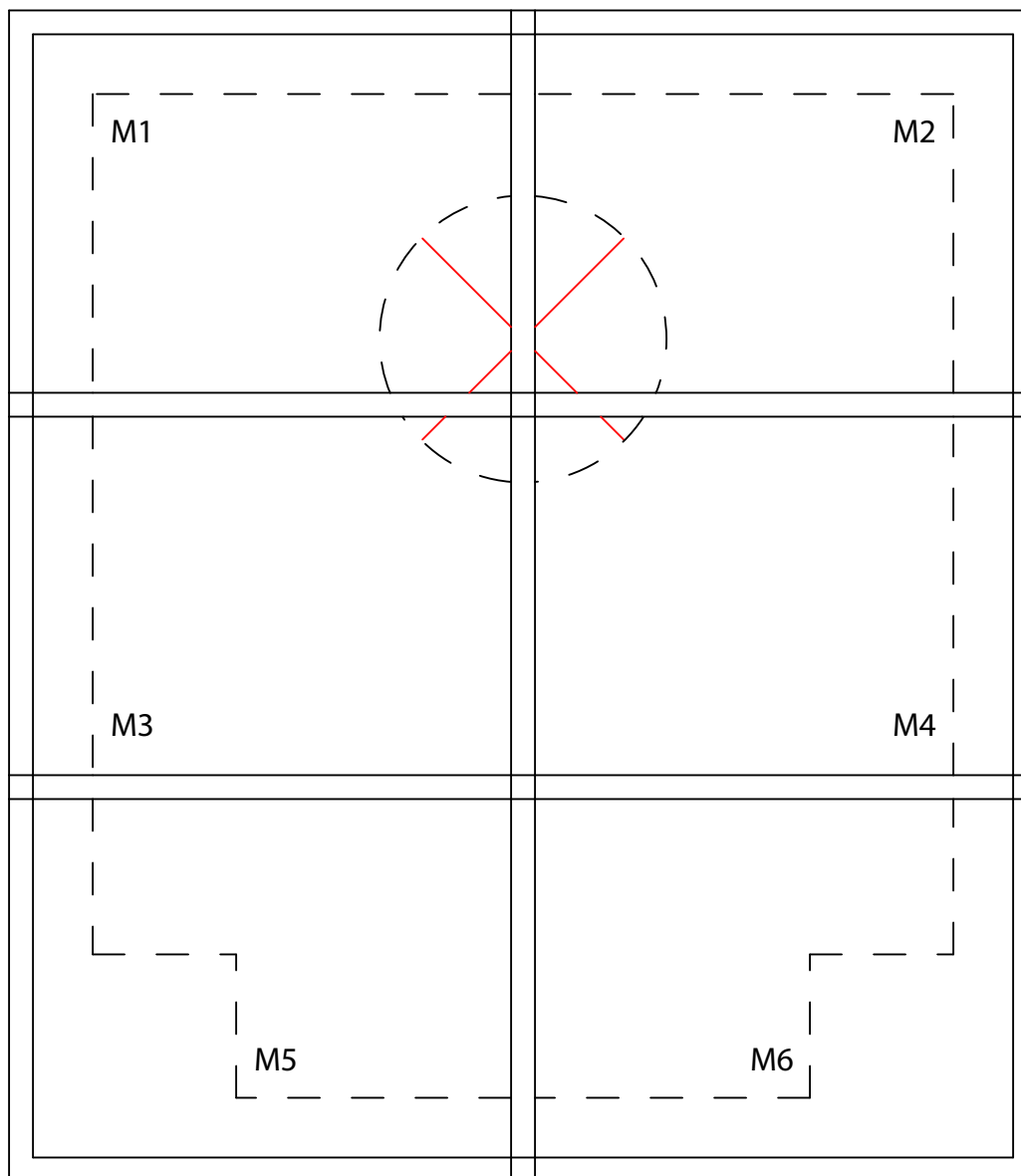

NOT TO SCALE

**M1**

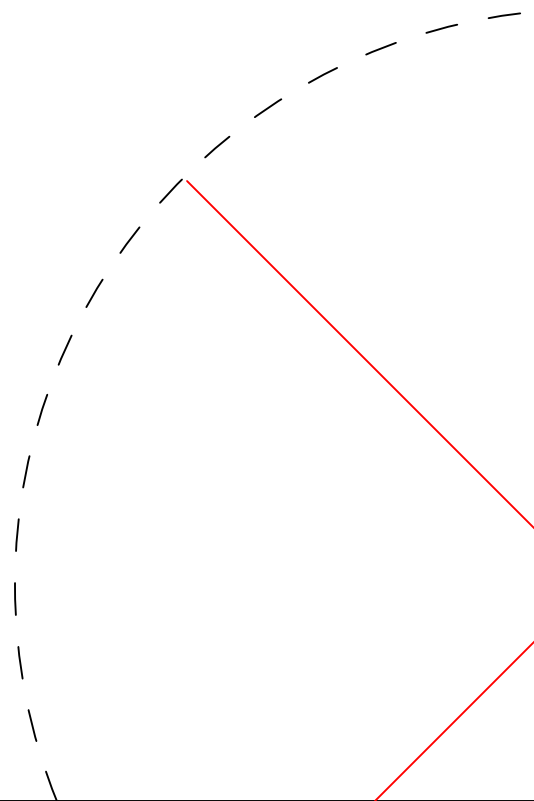

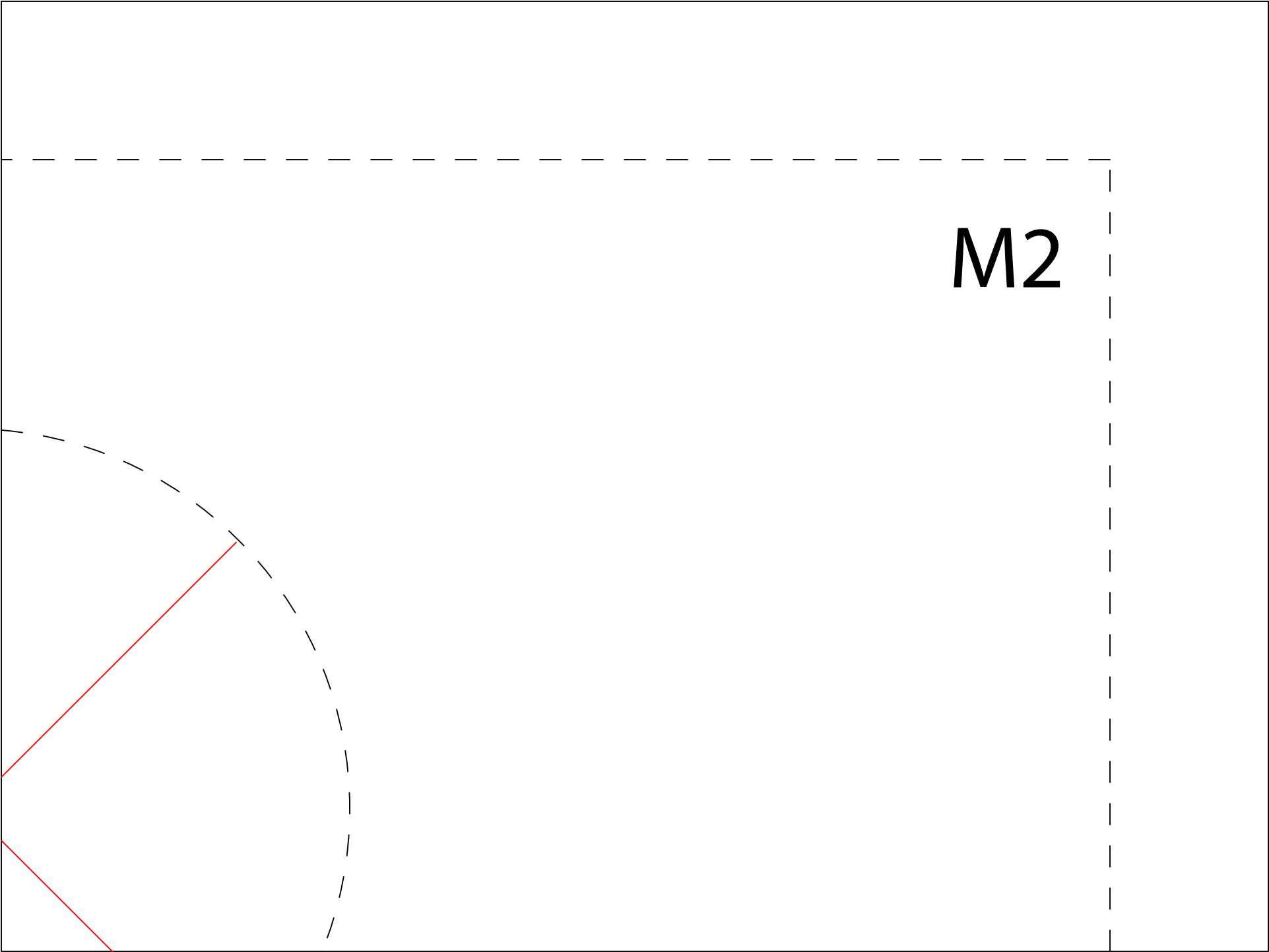

M2



A diagram within a rectangular frame. On the left side, there is a vertical dashed line. In the lower-left quadrant, the text 'M3' is written in a bold, black, sans-serif font. In the upper-right quadrant, there is a curved dashed line. A solid red line segment is drawn from the top edge of the frame down to the curved dashed line.

**M3**



M4



**M5**



**M6**